

# L-011-P-MH

**LAMP TYPE: MR16 metal halide, GX10 bi-pin base, ANSI type M130 or M156**  
**Maximum 39 Watts**  
**SUITABLE FOR WET LOCATIONS.**

**WARNING** — Risk of Electric Shock. Verify that power is OFF before installing this fixture. This fixture must be installed in accordance with the National Electric Code and/or local codes. Failure to do so may result in serious personal injury or death. Wiring must be done by a licensed electrician.

## INSTALLATION

This fixture is to be mounted to an anchored junction box or in-ground mounting spike.

1. Verify that the power is off.
2. Feed the wire leads from the fixture through the locknut and junction box/ground spike cover.
3. Thread the locknut fully onto the swivel base and then thread the swivel into the junction box/ground spike cover.
4. Aim the fixture and tighten the locknut down tight to the junction box or spike cover.
5. Use silicone-filled wire nuts to join the white fixture wires to the output wires of the remote ballast (by others); type M130 for 39 Watt lamp, type M156 for 20 Watt lamp. Use silicone or electrical tape around wire nuts to ensure proper connection.
6. Push the connections into the junction box/ground spike and attach cover.
7. Adjust the angle of the fixture head to the desired position and tighten the swivel with a 5/32" hex wrench.

## LAMPING

1. Unscrew housing from base by turning housing counterclockwise.
2. Holding the lamp at its base, rotate it almost 1/4 turn counter-clockwise and pull up to remove.
3. Holding the new lamp at its base, insert the pins into the socket and turn clockwise until it stops.
4. Screw the housing back onto the fixture base. Do not overtighten.

## SECURING GOBO

1. Unscrew end cap from housing. This will take several revolutions.
2. Remove stainless steel snap ring from inside the housing. This is the ring with a round cross section and closest to the front of the fixture. This fixture accepts gobos that are 50 - 51.5 mm in diameter.
3. Place gobo up against the non-removable retention ring. Be sure to consider the orientation of the gobo pattern and its alignment with the vertical axis of the swivel.
4. Secure the gobo by reinserting the snap ring.
5. Reattach the end cap by slowly sliding the cap over the o-ring on the housing. Allow threads to catch and tighten one or two revolutions.
6. With fixture power on, continue threading the end cap onto housing to adjust focus of the projected image.

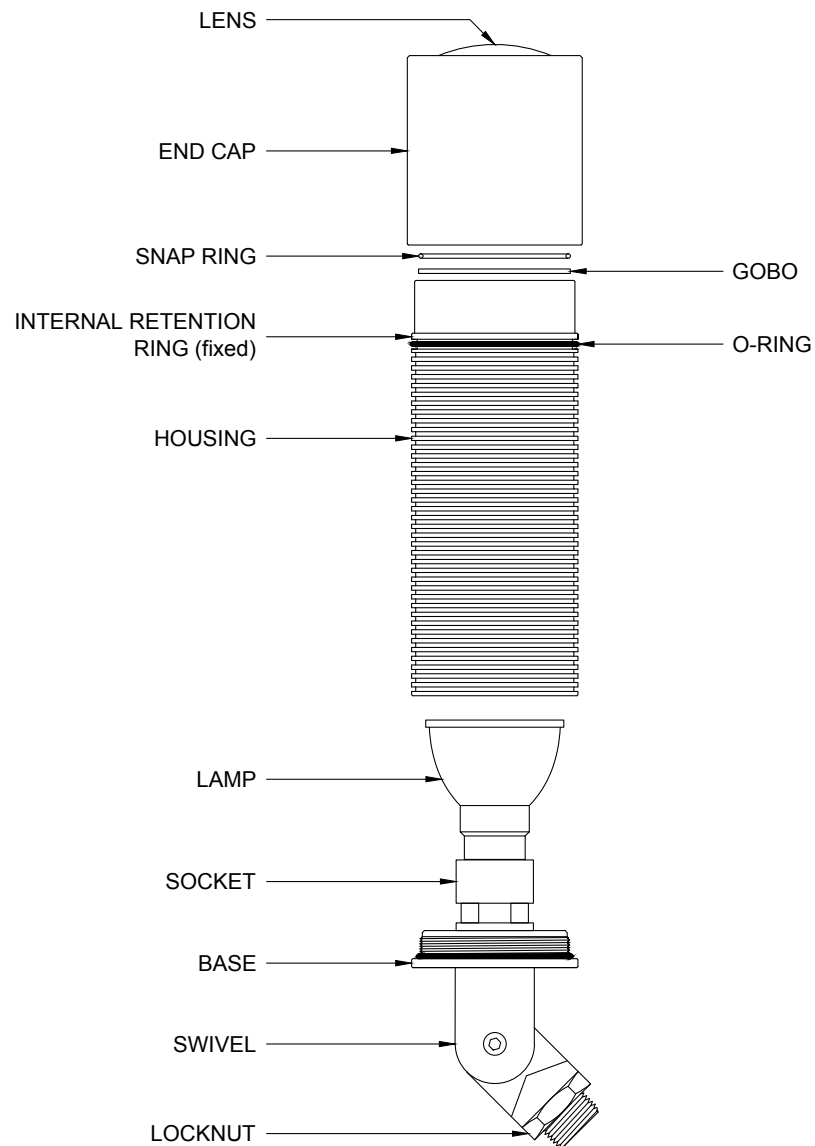

808-405-6732

www.BeachsideLighting.com

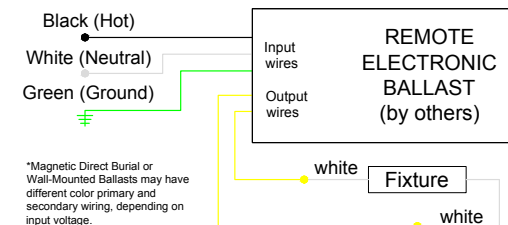

\*Magnetic Direct Burial or Wall-Mounted Ballasts may have different color primary and secondary wiring, depending on input voltage.

CSA Listed, file # 190030