

L-011-P 12V

**LAMP TYPE: MR16, GU5.3 bi-pin base, maximum 20 Watts LED, 50 Watts halogen
FOR OUTDOOR USE ONLY**

WARNING — Risk of Electric Shock. Install all luminaires 10 feet (3.05 m) or more from a pool, spa, or fountain. Verify that power is OFF before installing this fixture. This fixture must be installed in accordance with the National Electric Code and/or local codes. Failure to do so may result in serious personal injury or death. Wiring must be done by a licensed electrician.

INSTRUCTIONS PERTAINING TO A RISK OF FIRE, OR INJURY TO PERSONS IMPORTANT SAFETY INSTRUCTIONS

Lighted lamp is HOT!

WARNING – To reduce the risk of FIRE OR INJURY TO PERSONS:

- Turn off/unplug and allow to cool before replacing lamp.
- Lamp gets HOT quickly! Contact only switch/plug when turning on. Low voltage luminaires can become very hot, depending on the lamp wattage used. Glass lens and metal areas around lamp can become hot enough to blister hands. Particular care should be taken not to locate fixtures where small children can reach them if higher wattages are used.
- Do not touch hot lens, guard, or enclosure.
- Keep lamp away from materials that may burn.
- Do not touch the lamp at any time. Use a soft cloth. Oil from skin may damage lamp.
- Do not operate the luminaire fitting with a missing or damaged cap assembly.

SAVE THESE INSTRUCTIONS

This is a low-voltage fixture for use with maximum 25A, 15V power units only. A remote transformer is required. Do not overload the transformer by installing or relamping with higher wattage lamps that together exceed the capacity of the transformer. The low-voltage cable shall: a) be protected by routing in close proximity to the luminaire or fitting, or next to a building structure such as a house or deck; b) not be buried except for a maximum 6 inches (15.2 cm) in order to connect to the main low-voltage cable; and c) have the length cut off so that it is connected to a connector within 6 inches (15.2 cm) from a building structure, a luminaire, or fitting. Contact Beachside Lighting for direct burial wire for use as main secondary wiring.

INSTALLATION

This fixture is to be mounted to an anchored junction box or in-ground mounting spike.

1. Verify that the power is off.
2. Feed the wire leads from the fixture through the Locknut and junction box/ground spike cover.
3. Thread the Locknut fully onto the Swivel base and then thread the Swivel into the junction box/ground spike cover.
4. Aim the fixture and tighten the Locknut down tight to the junction box or spike cover.
5. Use silicone-filled wire nuts to join the fixture wires to the wires from the power source. Use silicone or electrical tape around wire nuts to ensure proper connection.
6. Push the connections into the junction box/ground spike and attach cover.
7. Adjust the angle of the fixture head to the desired position and tighten the Swivel with a 5/32" hex wrench.

LAMPING

1. Remove the Housing by unscrewing it counterclockwise. It will separate at the Base.
2. Holding the lamp at its base, pull straight up to remove from socket.
3. Holding the new lamp at its base, align the lamp pins with the holes in the socket and insert by pushing straight down.
4. Screw the Housing back onto the fixture Base. Do not overtighten.

SECURING GOBO

1. Unscrew End Cap from Housing. This will take several revolutions.
2. Remove stainless steel Snap Ring from inside the housing. This is the ring with a round cross section and closest to the front of the fixture.
3. This fixture accepts Gobos that are 50 - 51.5 mm in diameter. Place Gobo up against the non-removable Retention Ring. Be sure to consider the orientation of the Gobo pattern and its alignment with the vertical axis of the Swivel.
4. Secure the Gobo by reinserting the Snap Ring.
5. Reattach the End Cap by slowly sliding it over the O-ring on the Housing. Allow threads to catch and tighten one or two revolutions.
6. With fixture power on, continue threading the end cap onto housing to adjust focus of the projected image.

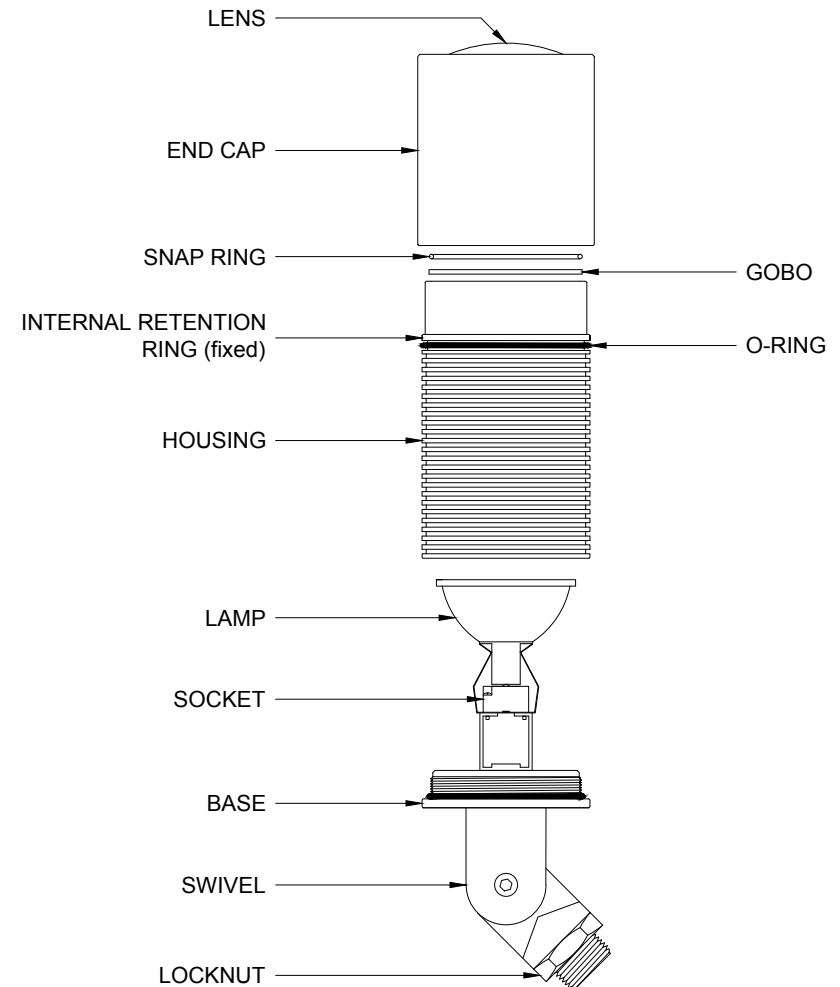

808-405-6732

www.BeachsideLighting.com

CSA Listed, file # 190030