

MB1 - 12V

LAMP TYPE: MR11 G4 bi-pin base — Maximum 20 Watts halogen or LED LED module — Maximum 3 Watts

SUITABLE FOR INDOOR OR OUTDOOR USE

WARNING — Risk of Electric Shock. Install all luminaires 10 feet (3.05 m) or more from a pool, spa, or fountain. Verify that power is OFF before installing this fixture. This fixture must be installed in accordance with the National Electric Code and/or local codes. Failure to do so may result in serious personal injury or death. Wiring must be done by a licensed electrician.

For luminaires equipped with halogen lamps:

INSTRUCTIONS PERTAINING TO A RISK OF FIRE OR INJURY TO PERSONS IMPORTANT SAFETY INSTRUCTIONS SAVE THESE INSTRUCTIONS

Lighted lamp is HOT!

WARNING — To reduce the risk of FIRE OR INJURY TO PERSONS:

- Turn off/unplug and allow to cool before replacing lamp.
- Lamp gets HOT quickly! Contact only switch/plug when turning on.
- Do not touch hot lens or faceplate.
- Keep lamp away from materials that may burn.
- Do not touch the lamp at any time. Use a soft cloth. Oil from skin may damage lamp.
- Do not operate the luminaire fitting with a missing or damaged faceplate or lens.

This is a low-voltage fixture for use with maximum 25A, 15V power units only. A remote transformer is required. Do not overload the transformer by installing or relamping with higher wattage lamps that together exceed the capacity of the transformer. The unit low-voltage cable shall: a) be protected by routing in close proximity to the luminaire or fitting, or next to a building structure such as a house or deck; b) not be buried except for a maximum 6 inches (15.2 cm) in order to connect to the main low-voltage cable; and c) have the length cut off so that it is connected to a connector within 6 inches (15.2 cm) from a building structure, a luminaire, or fitting. Contact Beachside Lighting for low voltage cable and direct burial wire for use as main secondary wiring.

INSTALLATION

NOTE: This fixture must be mounted to an anchored junction box or in-ground mounting spike.

1. Verify that the power is off.
2. Remove the junction box or ground spike cover and feed the fixture leads through it from the top.
3. Thread the cover onto the Plug. It must be turned on fully clockwise to ensure stability. **NOTE:** the Plug should not be removed from the Shaft. If the Plug rotates in the Shaft while installing the cover, tighten the set screw with a 5/64" hex wrench. Aiming will be done with the set screws in the Top in Step 6 after installation.
4. Use silicone-filled wire nuts to join fixture leads to wires from power source/transformer. Use silicone or electrical tape around wire nuts to ensure proper connection.
5. Push the connections into the junction box/ground spike and attach cover.
6. Aiming is accomplished by loosening the set screw at the lower edge of the Top with a 5/64" hex wrench, rotating the Top to the desired position, and tightening the set screw.

LAMPING - LIGHT ENGINE

This fixture has a long-life LED Module that should not need replacement for years. However, if a Module fails or technology improves and a new one is desired, replacements are available from Beachside Lighting (808-263-5717).

LAMPING - MR11

1. Make sure power to fixture is OFF.
2. Loosen — but do not remove — the set screw located at the lower edge of the Top with a 5/64" hex wrench. Lift it straight up to remove from the Union. There will be resistance from the o-ring.
3. Pull Lamp straight up to remove from Socket.
4. Align pins of new Lamp with holes in Socket and insert fully.

5. Reinstall the Top, applying grease appropriate for silicone to the o-ring as needed.
6. Rotate Top into desired position and tighten set screw.

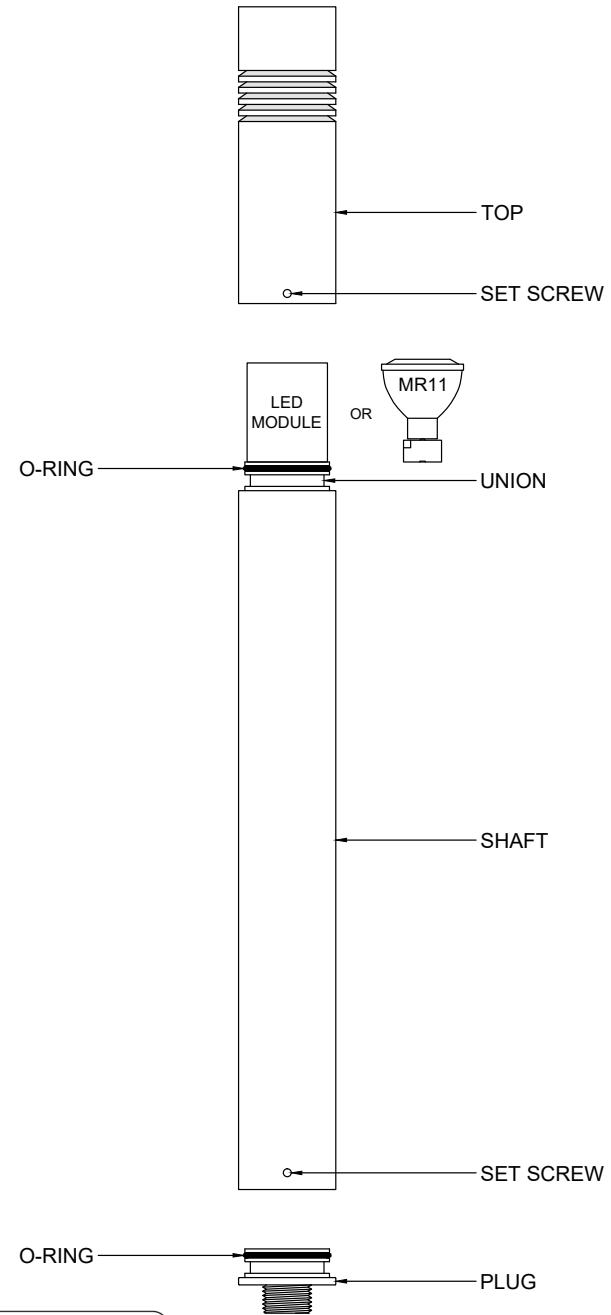

CSA Listed, File # 190030
www.BeachsideLighting.com
808-405-6732

