

L-012F

The L-012F is a cast brass steplight for surface-mount applications.

Construction Cast brass faceplate.

Lens Tempered, frosted dome glass

Voltage 12 Volts AC. Remote transformer required.

Mounting Surface mount to wall. Mounting bracket allows for use with 4-inch octagonal box with standard diagonal hole spacing.

Installation Options & Lamps

Combustible installation (wood) only

	— 1W-G4	1 Watt LED (2800K - Warm White)
	— 3W-G4	3 Watt LED (2800K - Warm White)
G4 base		
max 15 Watts xenon	— 10X	10 Watt Xenon
max 10 Watts halogen	— 15X	15 Watt Xenon
	— 10H	10 Watt Halogen

NON-Combustible installation (masonry) only

	— 1W-G4	1 Watt LED (2800K - Warm White)
	— 3W-G4	3 Watt LED (2800K - Warm White)
G4 base		
max 20 Watts xenon	— 10X	10 Watt Xenon
max 35 Watt halogen	— 15X	15 Watt Xenon
	— 20X	20 Watt Xenon
	— 10H	10 Watt Halogen
	— 20H	20 Watt Halogen
	— 35H	35 Watt Halogen

Finish: Unfinished is standard; no specification required. The fixture will weather to a natural patina. The patina process is natural with brass and copper. Rate of patina and eventual color is dependent upon climate and proximity to the ocean. Thus, Beachside does not guarantee any specific appearance.

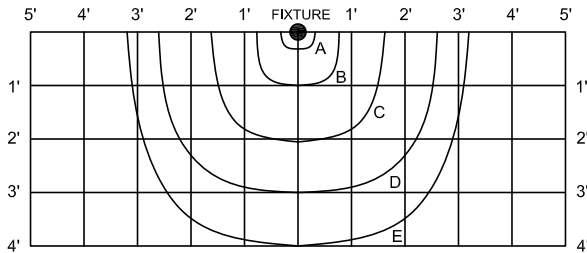

Horizontal Footcandles at Floor Level with Fixture Mounted at 18" High					
Lamp	A	B	C	D	E
1W	2.37	0.83	0.26	0.12	0.06
3W-G4	9.1	4.0	1.8	0.7	0.3
10X	7.5	3.5	1.1	0.3	0.1
15X	11.1	5.2	1.6	0.5	0.2
20X	15.0	7.0	2.2	0.7	0.2
10H	9.0	6.0	1.9	0.5	0.2
20H	18.0	12.0	4.0	1.0	0.5
35H	27.8	17.8	7.1	1.5	0.8

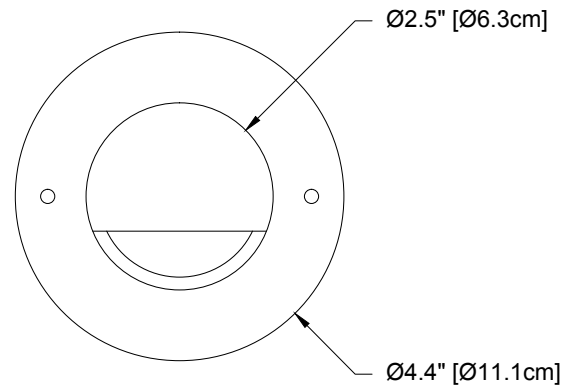
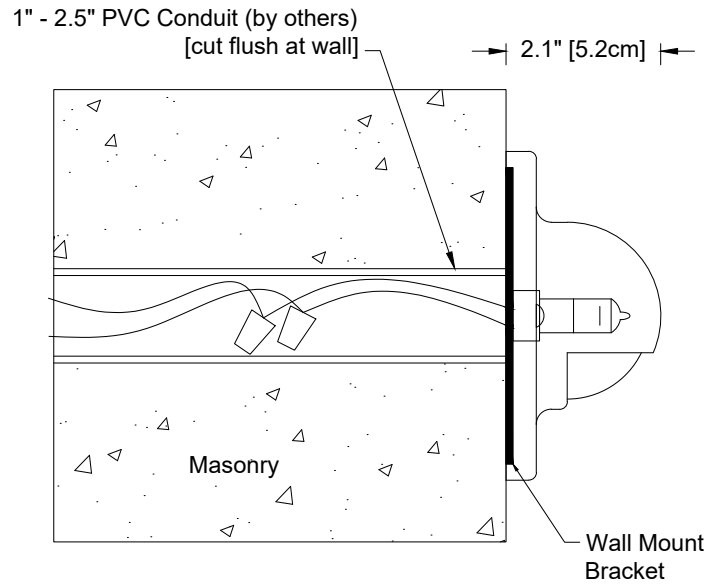
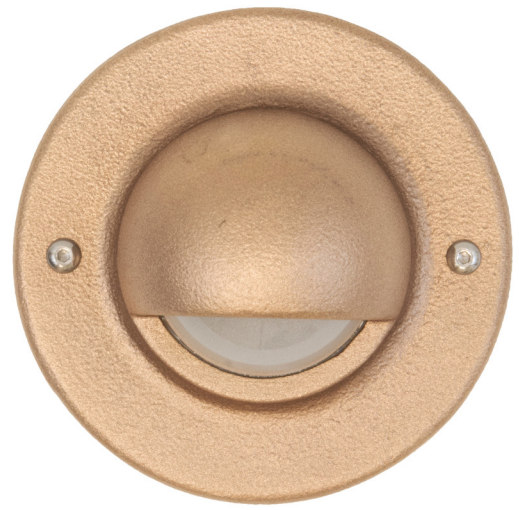

Weight: 1.4 lbs / 0.6 kg

IP66
10 year fixture warranty

Project _____	By _____	Date _____
For ordering purposes, please specify (example: L-012F—15X)		
L-012F	—	_____
Fixture	Lamp	_____